

We've teamed up with top-tier electricians to offer you nationwide professional EV charger installation services.

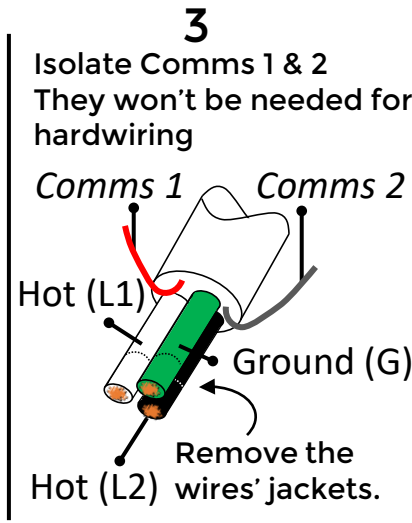

Visit our website and schedule your installation today!

apexcharger.com/contactlocalpartner

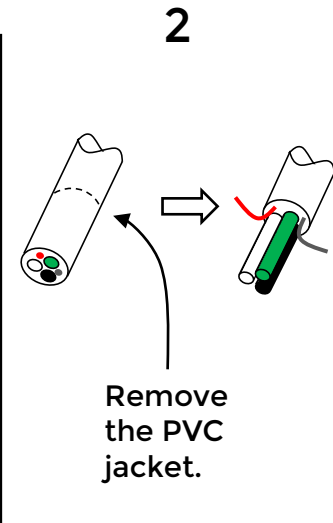
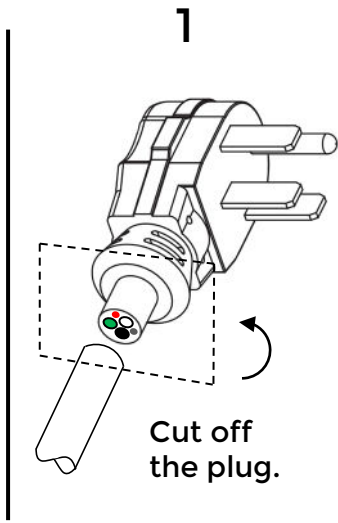

Need further assistance? Call us on (424) 213 8817 or reach out via e-mail at support@apexcharger.com; we'd love to hear from you!

APEX CHARGER

Hardwiring instructions for licensed electrical professionals.
For safety reasons, NEC recommends limiting the current to 80% of the circuit breaker's capacity.

4

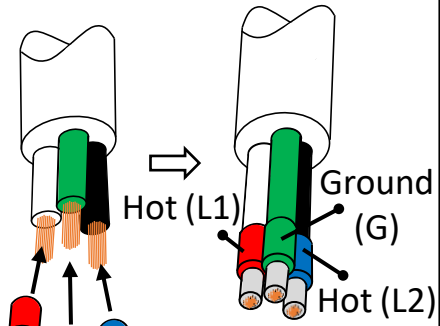

Install/crimp the tubular terminals onto the wires.

5

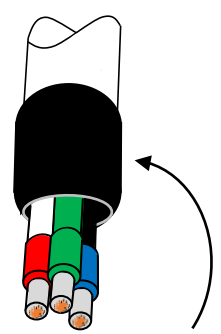

Secure the wires with the thermal rubber bracelet.

6

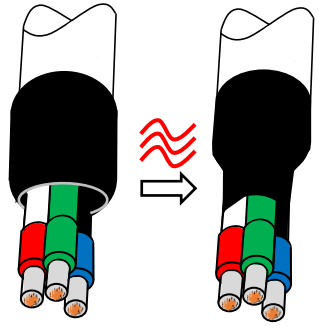

Apply heat to the rubber bracelet to mold it.

7

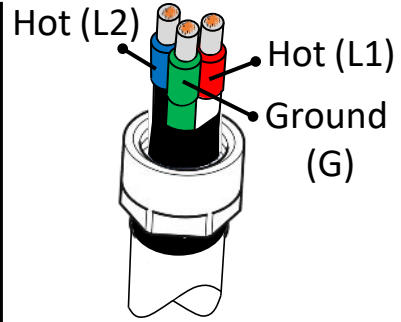

Connect the wires to the network and lock the cable in place (no neutral needed).

To achieve the charger's full 48A capacity, hardwire it to a dedicated 60A circuit breaker (no GFCI needed).
For NEMA 14-50 installation, use a 50A dedicated circuit breaker with GFCI protection and set the charger's current to 40A (max).

Need further assistance? Call us on (424) 213 8817 or reach out via e-mail at support@apexcharger.com; we'd love to hear from you!